

SHIMANO

CARDIFF A-RB

CDF-401A

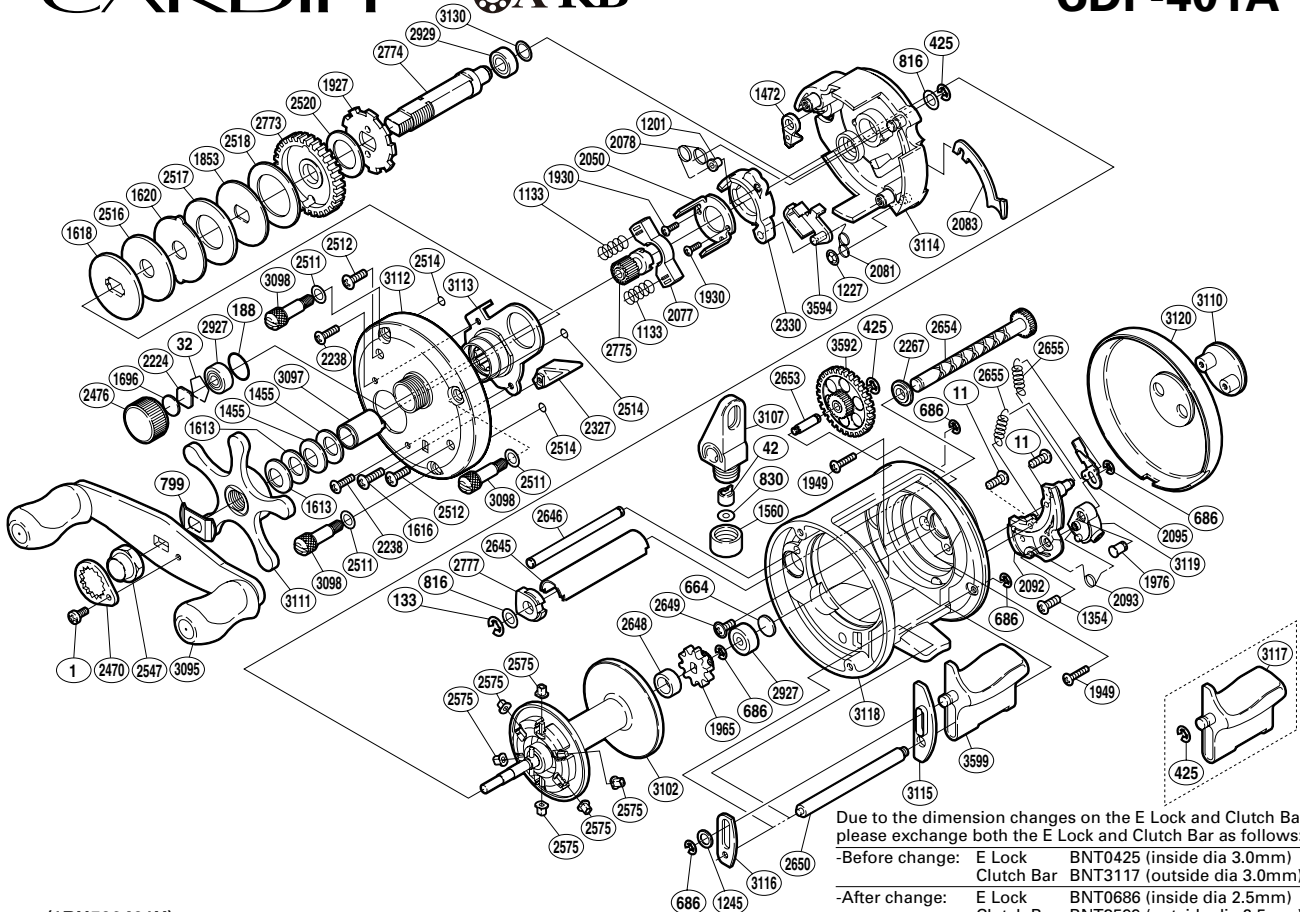

(1RH532401U)

If the wrong combination is used, the reel will not be properly repaired.

Part No.	Description	Part No.	Description	Part No.	Description
BNT0001	Screw	BNT1976	Click Shaft	BNT2653	Idle Gear B Shaft
BNT0011	Screw	BNT2050	Clutch Cam Retainer	BNT2654	Worm Shaft
BNT0032	Bearing Retainer	BNT2077	Yoke	BNT2655	Click Spring
BNT0042	Line Guide Pawl	BNT2078	Retractor Spring	BNT2773	Drive Gear
BNT0133	E Lock	BNT2081	Clutch Pawl Spring	BNT2774	Drive Shaft
BNT0188	O Ring	BNT2083	Clutch Plate	BNT2775	Pinion Gear
BNT0425	E Lock	BNT2092	Click Plate	BNT2777	Worm Bushing A
BNT0664	Spacer B	BNT2093	Click Switch Spring	BNT2927	Ball Bearing
BNT0686	E Lock	BNT2095	Click Pawl	BNT2929	Ball Bearing
BNT0799	Friction Washer	BNT2224	Spool Tension Spacer A	BNT3095	Handle Assembly
BNT0816	Washer	BNT2238	Screw	BNT3097	Roller Clutch Inner Tube
BNT0830	Space	BNT2267	Worm Bushing B	BNT3098	Side Plate Nut
BNT1133	Yoke Spring	BNT2327	Return Pin Guide	BNT3102	Spool Assembly
BNT1201	Retractor Spring Collar	BNT2330	Clutch Cam	BNT3107	Line Guide
BNT1227	Push Nut (SPN-2)	BNT2470	Handle Nut Plate	BNT3110	Side I.D. Plate
BNT1245	Spacer	BNT2476	Cast Control Cap	BNT3111	Star Drag
BNT1354	Screw	BNT2511	Washer	BNT3112	Left Side Plate
BNT1455	Drag Spring Washer H	BNT2512	Screw	BNT3113	Roller Clutch Assembly
BNT1472	Anti-Reverse Pawl	BNT2514	O Ring	BNT3114	Set Plate
BNT1560	Pawl Cap	BNT2516	Drag Washer AG	BNT3115	Clutch Button Guide A
BNT1613	Drag Spring Washer L	BNT2517	Drag Washer CG	BNT3116	Clutch Button Guide B
BNT1616	Screw	BNT2518	Drag Washer BG	BNT3118	One-Piece Frame
BNT1618	Key Washer C	BNT2520	Drive Shaft Washer B	BNT3119	Click Switch
BNT1620	Eared Washer	BNT2547	Handle Nut	BNT3120	Right Side Plate
BNT1696	Cast Control Spacer B	BNT2575	Brake Collar	BNT3130	Washer
BNT1853	Key Washer A	BNT2645	Level Wind Guard	BNT3592	Idle Gear B
BNT1927	Anti-Reverse Ratchet	BNT2646	Stabilizer Bar	BNT3594	Clutch Pawl
BNT1930	Screw	BNT2648	Idle Gear A Bush	BNT3599	Quick-Fire II Clutch Bar
BNT1949	Screw	BNT2649	Screw		
BNT1965	Idle Gear A	BNT2650	Clutch Button Support Bar		

(181010)